

AECOM
AECOM House, 63-77 Victoria Street,
St. Albans, Hertfordshire, AL1 3ER
+44(0)1727 535000 tel
+44(0)1727 535099 fax
www.aecom.com

1. ALL DIMENSIONS ARE IN METRES UNLESS NOTED OTHERWISE
2. ALL JUNCTION LAYOUTS AREA INDICATIVE
3. THIS DRAWING IS BASED ON ORDNANCE SURVEY MASTERMAP MAPPING, AND AS SUCH, ALL INFORMATION SHOWN IS APPROXIMATE ONLY.
4. ALL ROAD WIDTHS SHOWN, AS WELL AS POSITIONS OF EXISTING STREET FURNITURE, ARE APPROXIMATE ONLY.
5. VEHICLE TRACKING SHOWN IS INDICATIVE ONLY, AND REPRESENTS ASSUMED DELIVERY ROUTE(S) AND APPROXIMATE VEHICLE SIZE. SPECIFIC VEHICLE TO BE DETERMINED BY EQUIPMENT SUPPLIER / HAULIER.
6. DEFINITIVE VEHICLE TRACKING OF SPECIFIC DELIVERY VEHICLE TO BE CARRIED OUT BY HAULIER, TO ENSURE DESIRED MANOEUVRES ARE ACHIEVABLE, AND TO CONFIRM ANY REQUIRED ROAD WIDENING, TEMPORARY WORKS, etc.
7. ORDER LIMITS ARE TO THE OUTER EDGE OF THE RED LINE, WHICH IS AS PER PUBLISHED IN THE DCO DOCUMENTATION.

TRAFFIC REGULATION MEASURES

TO PROVIDE SAFE ENTRY AND EGRESS OF THE NEWMARKET ROAD SITE ACCESS, TEMPORARY TRAFFIC SIGNALS AND TEMPORARY SPEED LIMIT REDUCTIONS ARE PROPOSED WHILST THE SITE ACCESS IS IN USE DURING THE CONSTRUCTION PERIOD. THESE ARE SHOWN ON SHEET NUMBER 60589004-TRM-TM-004 AND 60589004-TRM-TM-005 IN THE TRAFFIC REGULATION MEASURES PLAN TEMPORARY MEASURES.

ISSUE/REVISION

I/R	DATE	DESCRIPTION
C	2023-03-03	DEADLINE 7
B	2022-11-28	MINOR UPDATE DEADLINE 3A
A	2022-11-11	FIRST ISSUE

KEY PLAN



PROJECT NUMBER

60589004

SHEET TITLE

CABLE ROUTE, SITE ACCESS J & K (CR-J)&(CR-K) A142/NEWMARKET ROAD
TEMPORARY TRAFFIC SIGNALS
AND VISIBILITY (SHEET 2 OF 2)
SHEET NUMBER

ACM-60589004-AMR-DR-0036

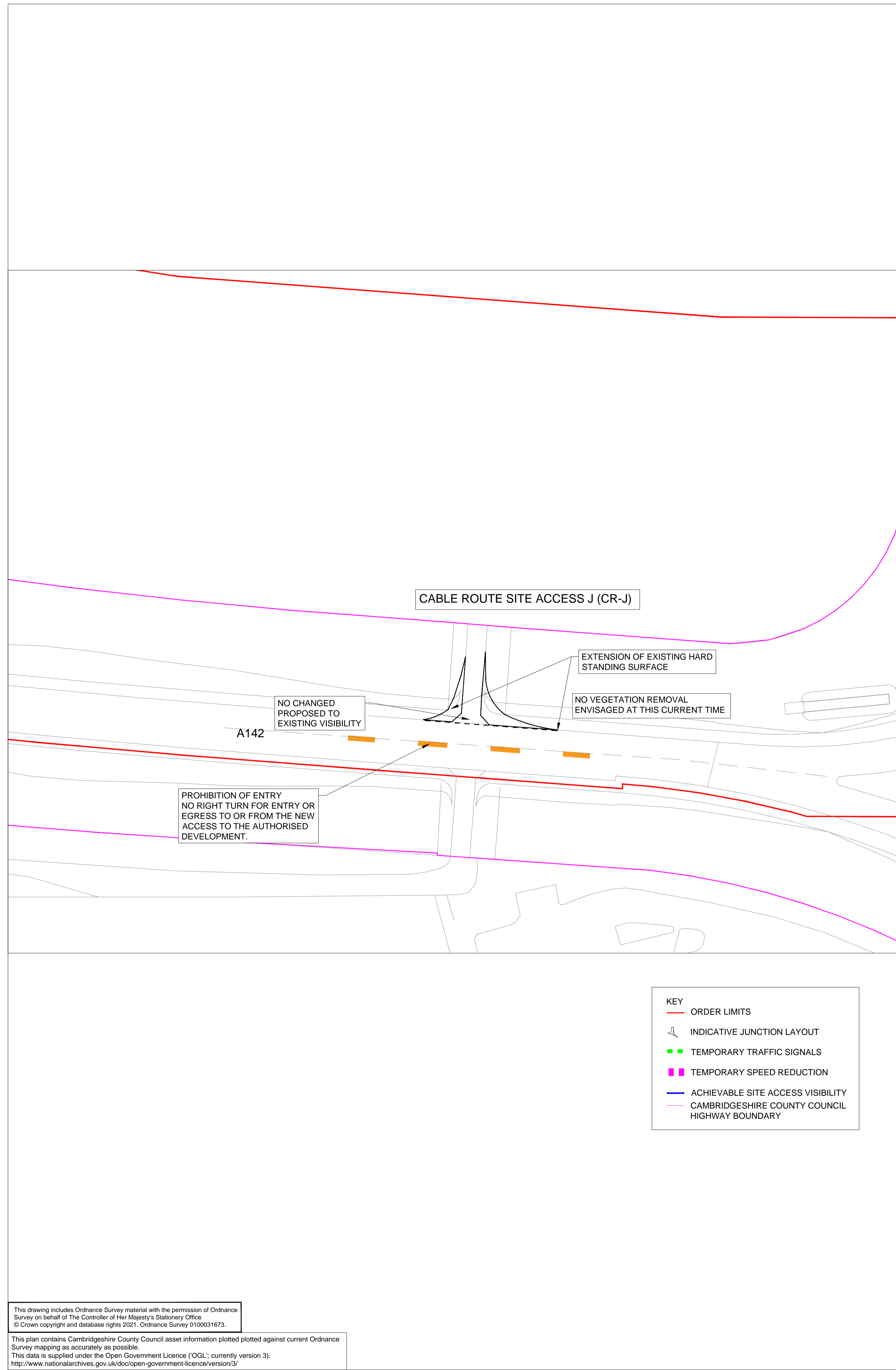

KEY	
	ORDER LIMITS
	INDICATIVE JUNCTION LAYOUT
	TEMPORARY TRAFFIC SIGNALS
	TEMPORARY SPEED REDUCTION
	ACHIEVABLE SITE ACCESS VISIBILITY
	CAMBRIDGESHIRE COUNTY COUNCIL HIGHWAY BOUNDARY

SUMMARY OF USE
THE ACCESS LOCATIONS ACROSS GRID CONNECTION ROUTES A AND B WILL BE RE-INSTATED TO THEIR CONDITION PRIOR TO THE CONSTRUCTION PHASE; HOWEVER, THE RIGHTS TO UTILISE THESE ACCESS POINTS WILL BE RETAINED DURING OPERATION AND SECURED THROUGH THE DCO TO ALLOW ACCESS FOR MAINTENANCE, IF REQUIRED. ACCESS TO THE GRID CONNECTION ROUTES A AND B IS NOT REQUIRED DURING DECOMMISSIONING AS THE CABLE AND INFRASTRUCTURE WILL REMAIN IN-SITU.

This drawing includes Ordnance Survey material with the permission of Ordnance Survey on behalf of The Controller of Her Majesty's Stationery Office. © Crown copyright and database rights 2021. Ordnance Survey 0100031673.
This plan contains Cambridgeshire County Council asset information plotted against current Ordnance Survey mapping as accurately as possible. This data is supplied under the Open Government Licence (OGL; currently version 3). <http://www.nationalarchives.gov.uk/doc/open-government-licence/version/3/>
Printed on 100% Post-Consumer Recycled Content Paper



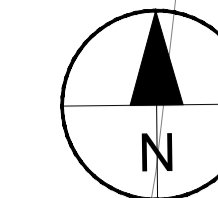

AECOM
AECOM House, 63-77 Victoria Street,
St. Albans, Hertfordshire, AL1 3ER
+44(0)1727 535000 tel
+44(0)1727 535099 fax
www.aecom.com

NOTE

1. ALL DIMENSIONS ARE IN METRES UNLESS NOTED OTHERWISE
2. ALL JUNCTION LAYOUTS AREA INDICATIVE
3. THIS DRAWING IS BASED ON ORDNANCE SURVEY MASTERMAP MAPPING, AND AS SUCH, ALL INFORMATION SHOWN IS APPROXIMATE ONLY.
4. ALL ROAD WIDTHS SHOWN, AS WELL AS POSITIONS OF EXISTING STREET FURNITURE, ARE APPROXIMATE ONLY.
5. VEHICLE TRACKING SHOWN IS INDICATIVE ONLY, AND REPRESENTS ASSUMED DELIVERY ROUTE(S) AND APPROXIMATE VEHICLE SIZE. SPECIFIC VEHICLE TO BE DETERMINED BY EQUIPMENT SUPPLIER / HAULIER.
6. DEFINITIVE VEHICLE TRACKING OF SPECIFIC DELIVERY VEHICLE TO BE CARRIED OUT BY HAULIER, TO ENSURE DESIRED MANOEUVRES ARE ACHIEVABLE, AND TO CONFIRM ANY REQUIRED ROAD WIDENING, TEMPORARY WORKS, etc.
7. ORDER LIMITS ARE TO THE OUTER EDGE OF THE RED LINE, WHICH IS AS PER PUBLISHED IN THE DCO DOCUMENTATION.

KEY

- ORDER LIMITS
- CAMBRIDGESHIRE COUNTY COUNCIL HIGHWAY BOUNDARY

SUMMARY OF USE

THE ACCESS LOCATIONS ACROSS GRID CONNECTION ROUTES A AND B WILL BE RE-INSTATED TO THEIR CONDITION PRIOR TO THE CONSTRUCTION PHASE; HOWEVER, THE RIGHTS TO UTILISE THESE ACCESS POINTS WILL BE RETAINED DURING OPERATION AND SECURED THROUGH THE DCO TO ALLOW ACCESS FOR MAINTENANCE, IF REQUIRED. ACCESS TO THE GRID CONNECTION ROUTES A AND B IS NOT REQUIRED DURING DECOMMISSIONING AS THE CABLE AND INFRASTRUCTURE WILL REMAIN IN-SITU.

ISSUE/REVISION

I/R	DATE	DESCRIPTION
D	2023-03-03	DEADLINE 7
C	2022-11-28	MINOR UPDATE DEADLINE 3A
B	2022-11-11	SECOND ISSUE
A	2022-09-23	FIRST ISSUE

KEY PLAN



PROJECT NUMBER

60589004

SHEET TITLE

CABLE ROUTE (CR-L)
SITE ACCESS L
A142

SHEET NUMBER

ACM-60589004-AMR-DR-0037

CABLE ROUTE SITE ACCESS L (CR-L)

CABLE ROUTE SITE ACCESS L (CR-L)

WORKS NOT ENVISAGED AT THIS CURRENT TIME

WORKS NOT ENVISAGED AT THIS CURRENT TIME

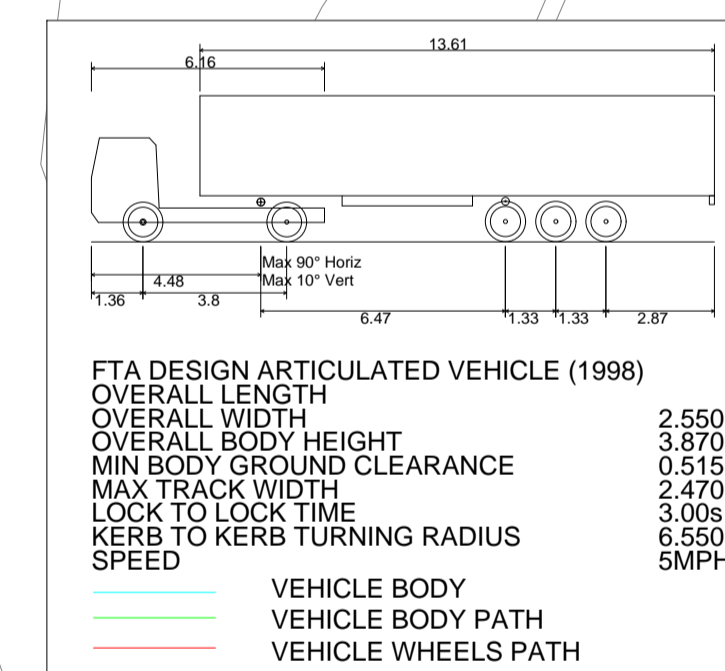

10.9M

10.9M

A142

A142

SWEPT PATH ANALYSIS - HGV - LEFT TURN ONTO A142 - EGRESS

SWEPT PATH ANALYSIS - HGV - RIGHT TURN FROM A142 - ENTRY

This drawing includes Ordnance Survey material with the permission of Ordnance Survey on behalf of The Controller of Her Majesty's Stationery Office © Crown copyright and database rights 2021. Ordnance Survey 0100031673.

This plan contains Cambridgeshire County Council asset information plotted against current Ordnance Survey mapping as accurately as possible. This data is supplied under the Open Government Licence (OGL; currently version 3). <http://www.nationalarchives.gov.uk/doc/open-government-licence/version/3/>



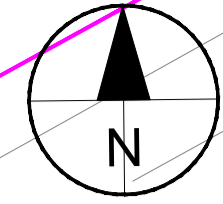

AECOM
AECOM House, 63-77 Victoria Street,
St. Albans, Hertfordshire, AL1 3ER
+44(0)1727 535000 tel
+44(0)1727 535099 fax
www.aecom.com

1. ALL DIMENSIONS ARE IN METRES UNLESS NOTED OTHERWISE
2. ALL JUNCTION LAYOUTS AREA INDICATIVE
3. THIS DRAWING IS BASED ON ORDNANCE SURVEY MASTERMAP MAPPING, AND AS SUCH, ALL INFORMATION SHOWN IS APPROXIMATE ONLY.
4. ALL ROAD WIDTHS SHOWN, AS WELL AS POSITIONS OF EXISTING STREET FURNITURE, ARE APPROXIMATE ONLY.
5. VEHICLE TRACKING SHOWN IS INDICATIVE ONLY, AND REPRESENTS ASSUMED DELIVERY ROUTE(S) AND APPROXIMATE VEHICLE SIZE. SPECIFIC VEHICLE TO BE DETERMINED BY EQUIPMENT SUPPLIER / HAULIER.
6. DEFINITIVE VEHICLE TRACKING OF SPECIFIC DELIVERY VEHICLE TO BE CARRIED OUT BY HAULIER, TO ENSURE DESIRED MANOEUVRES ARE ACHIEVABLE, AND TO CONFIRM ANY REQUIRED ROAD WIDENING, TEMPORARY WORKS, etc.
7. ORDER LIMITS ARE TO THE OUTER EDGE OF THE RED LINE, WHICH IS AS PER PUBLISHED IN THE DCO DOCUMENTATION.
8. ON-SITE MEASUREMENTS RECORDED BY AECOM ON 05/08/2022.

- ORDER LIMITS
- INDICATIVE JUNCTION LAYOUT
- CAMBRIDGESHIRE COUNTY COUNCIL HIGHWAY BOUNDARY

TO PROVIDE SAFE ENTRY AND EGRESS OF THE SITE ACCESSES, TEMPORARY TRAFFIC SIGNALS AND TEMPORARY SPEED LIMIT REDUCTIONS ARE PROPOSED WHILST THE SITE ACCESSES ARE IN USE DURING THE CONSTRUCTION PERIOD. THESE ARE SHOWN ON SHEET NUMBER 60589004-TRM-TM-007 AND 60589004-TRM-TM-008 IN THE TRAFFIC REGULATION MEASURES PLAN TEMPORARY MEASURES.

I/R	DATE	DESCRIPTION
D	2023-03-03	DEADLINE 7
C	2022-11-28	MINOR UPDATE DEADLINE 3A
B	2022-11-11	SECOND ISSUE
A	2022-09-23	FIRST ISSUE



60589004

CABLE ROUTE (CR-M) & (CR-N)
SITE ACCESS M & N
CHIPPENHAM ROAD

ACM-60589004-AMR-DR-0038

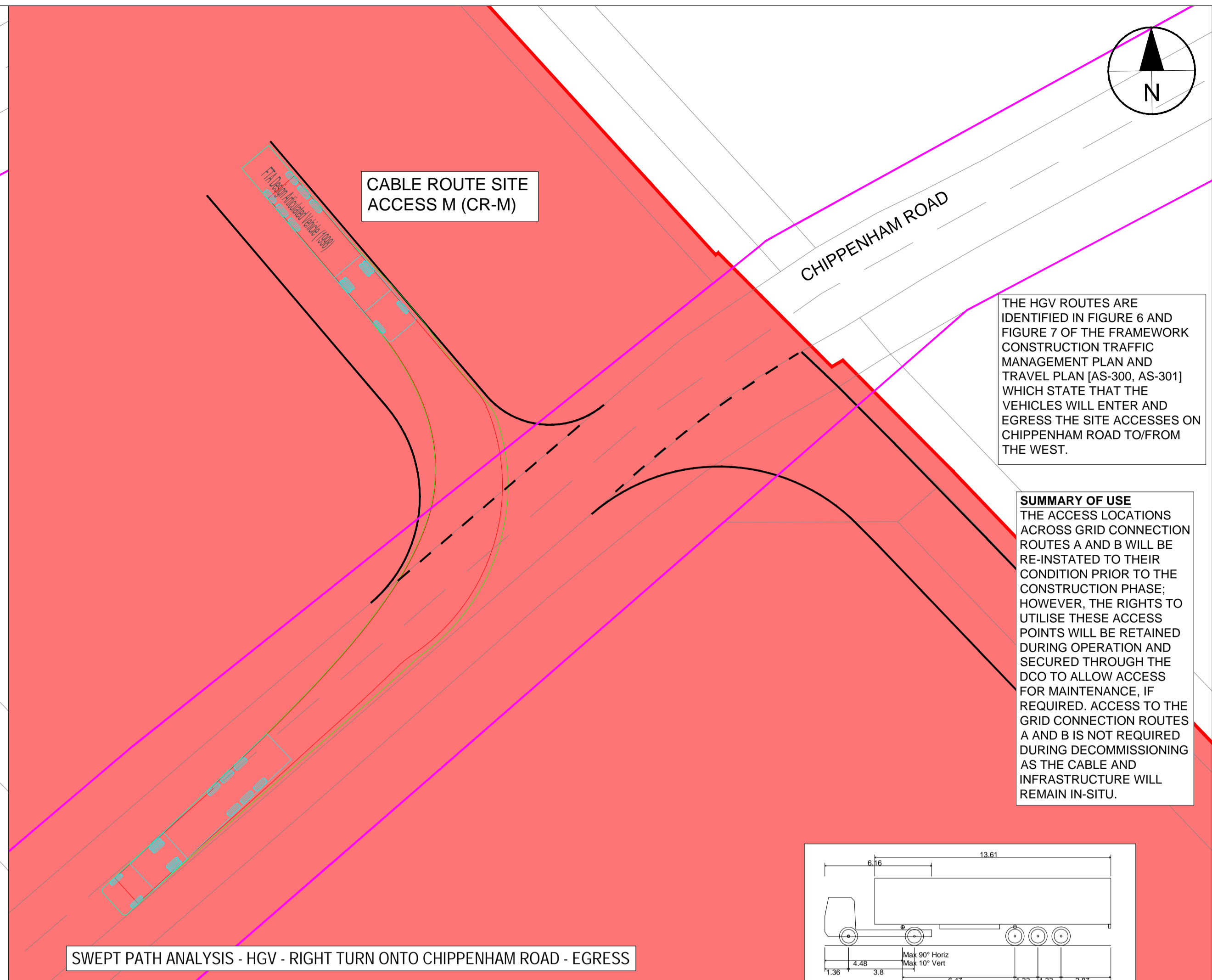
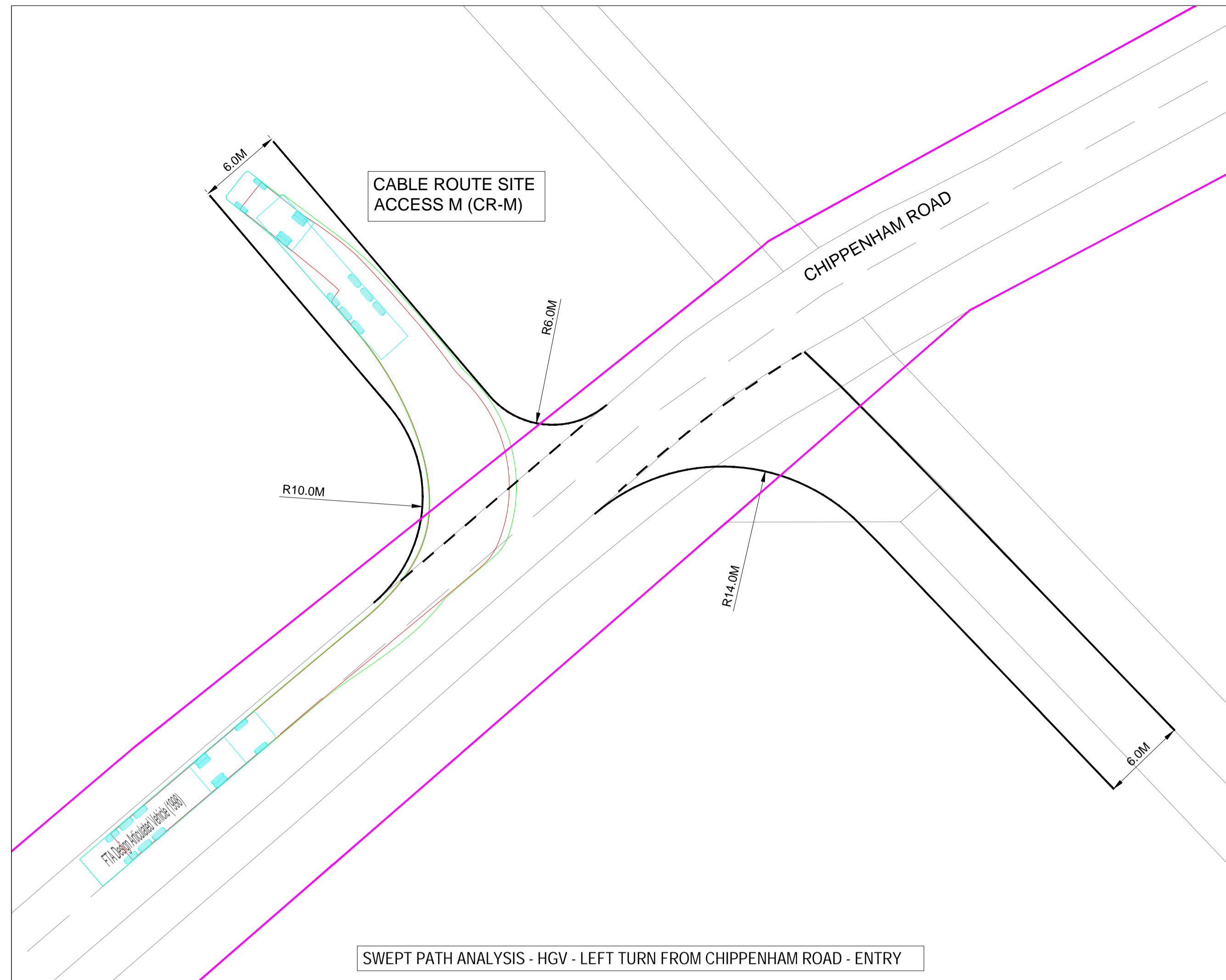

THE HGV ROUTES ARE IDENTIFIED IN FIGURE 6 AND FIGURE 7 OF THE FRAMEWORK CONSTRUCTION TRAFFIC MANAGEMENT PLAN AND TRAVEL PLAN (AS-300, AS-301) WHICH STATE THAT THE VEHICLES WILL ENTER AND EGRESS THE SITE ACCESSES ON CHIPPENHAM ROAD TO/FROM THE WEST.

SUMMARY OF USE
THE ACCESS LOCATIONS ACROSS GRID CONNECTION ROUTES A AND B WILL BE RE-INSTATED TO THEIR CONDITION PRIOR TO THE CONSTRUCTION PHASE; HOWEVER, THE RIGHTS TO UTILISE THESE ACCESS POINTS WILL BE RETAINED DURING OPERATION AND SECURED THROUGH THE DCO TO ALLOW ACCESS FOR MAINTENANCE, IF REQUIRED. ACCESS TO THE GRID CONNECTION ROUTES A AND B IS NOT REQUIRED DURING DECOMMISSIONING AS THE CABLE AND INFRASTRUCTURE WILL REMAIN IN-SITU.

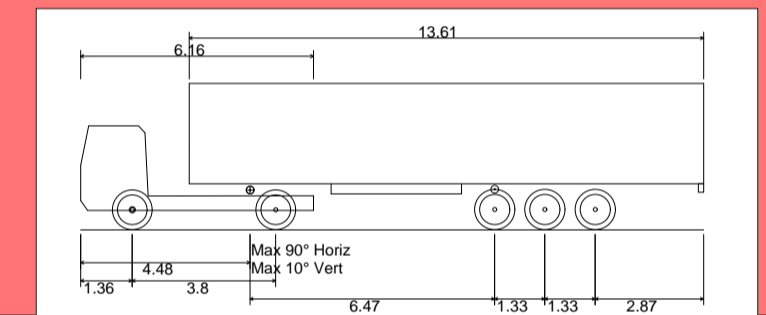

VEHICLE BODY	VEHICLE BODY PATH	VEHICLE WHEELS PATH
--------------	-------------------	---------------------

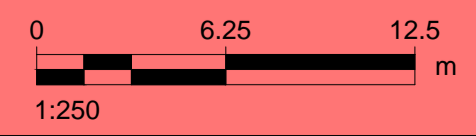
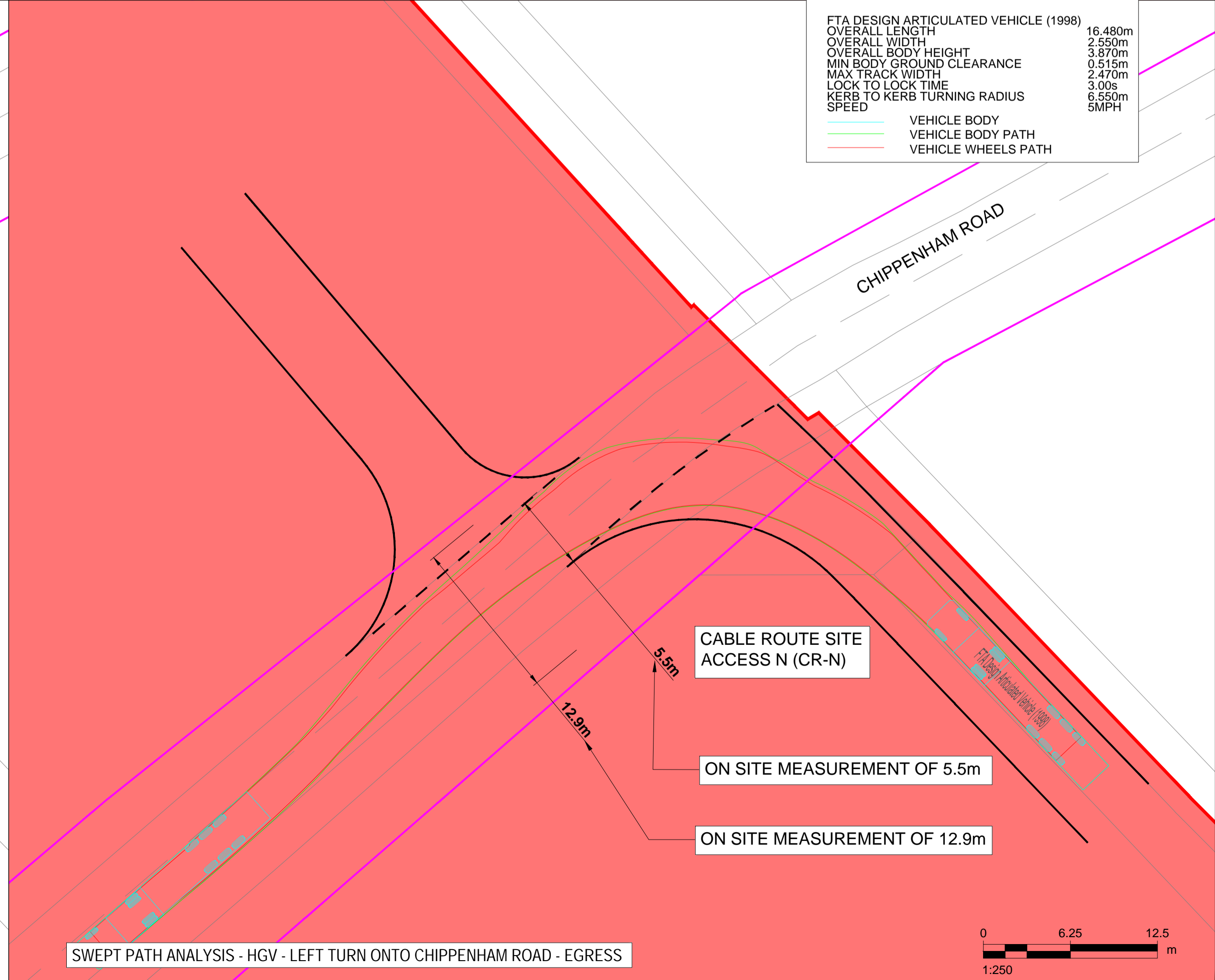
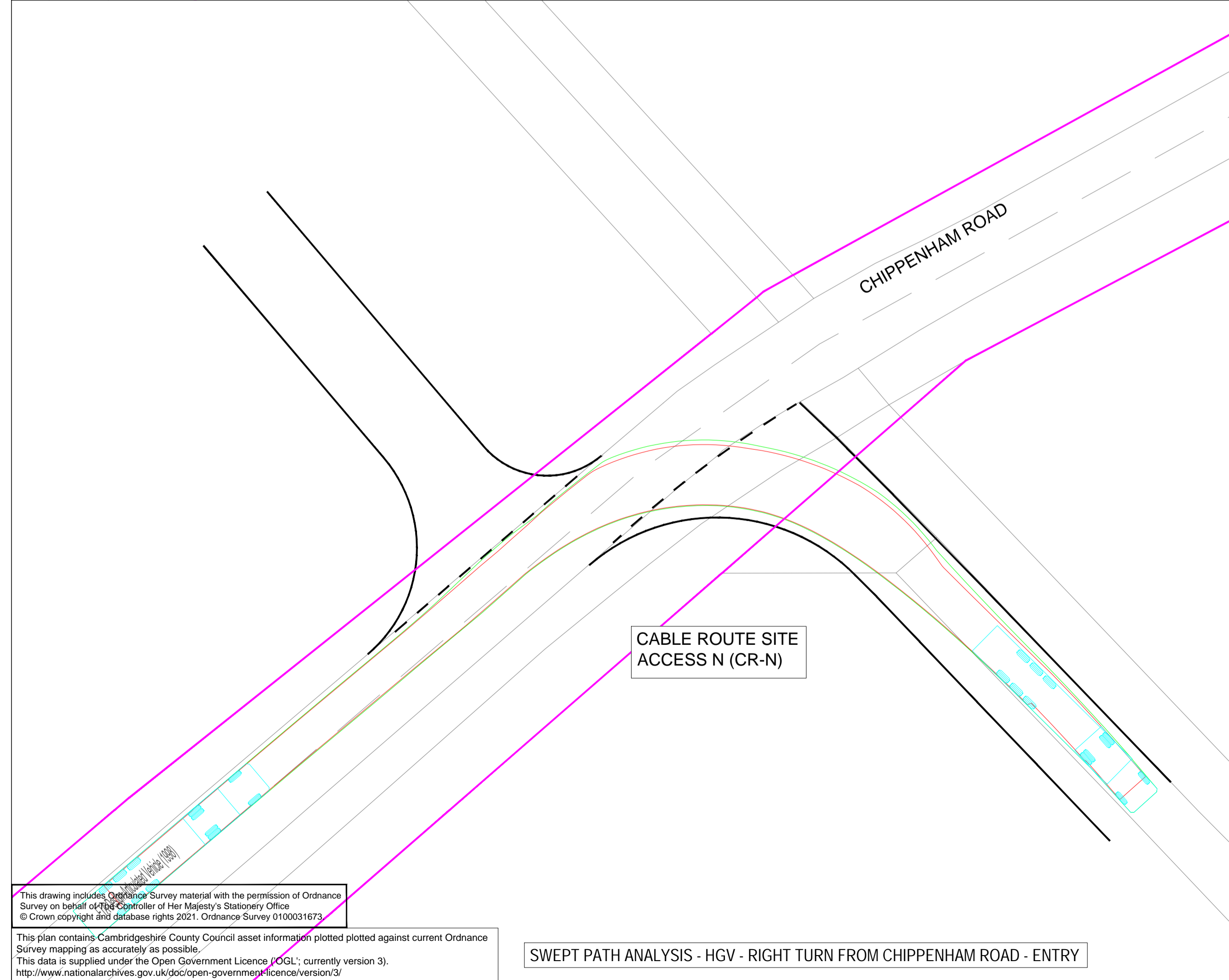

This drawing includes Ordnance Survey material with the permission of Ordnance Survey on behalf of Her Majesty's Stationery Office. © Crown copyright and database rights 2021. Ordnance Survey 0100031673.
This plan contains Cambridgeshire County Council asset information plotted against current Ordnance Survey mapping as accurately as possible. This data is supplied under the Open Government Licence (OGL; currently version 3). <http://www.nationalarchives.gov.uk/doc/open-government-licence/version/3/>

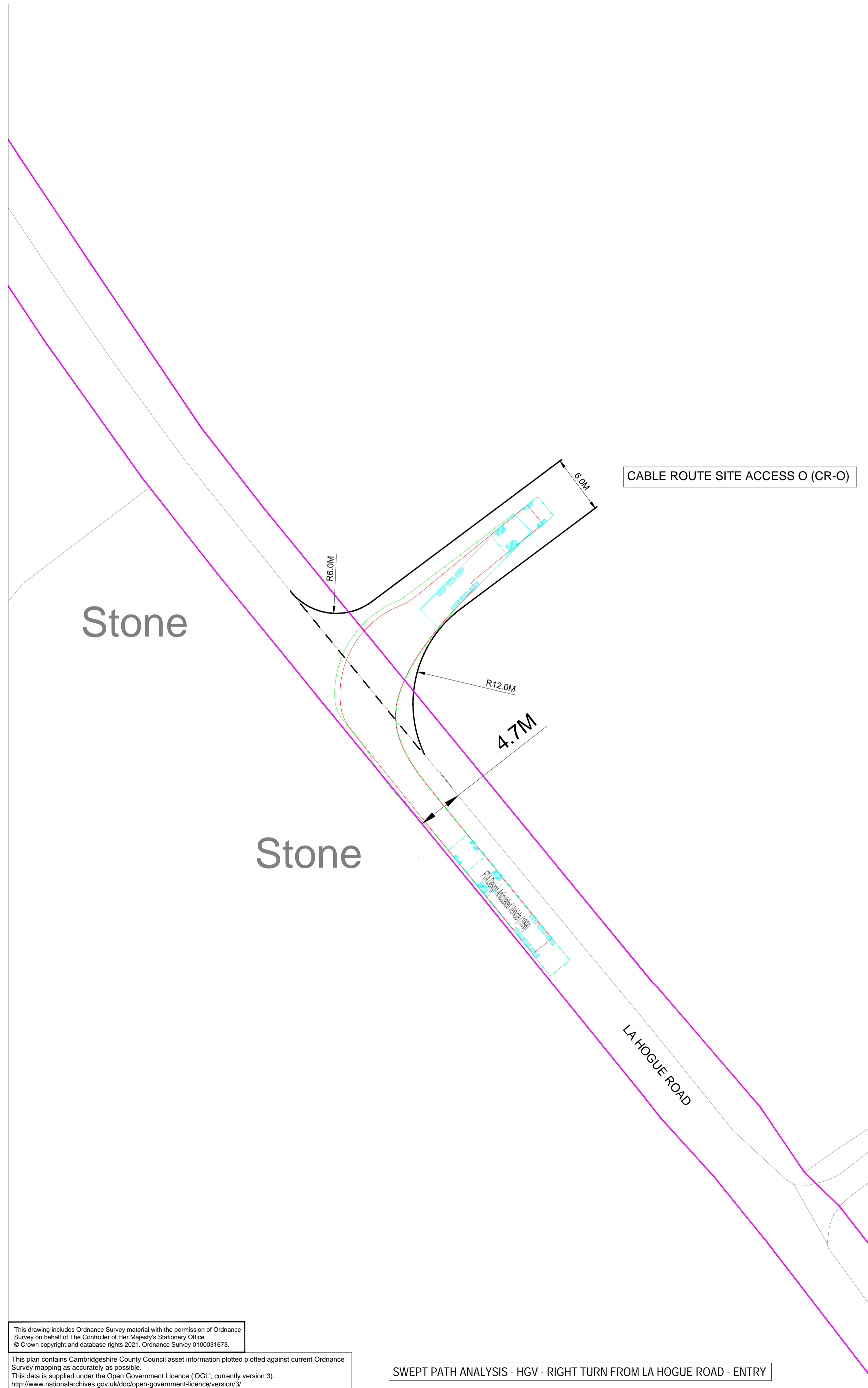

SWEPT PATH ANALYSIS - HGV - RIGHT TURN FROM LA HOGUE ROAD - ENTRY

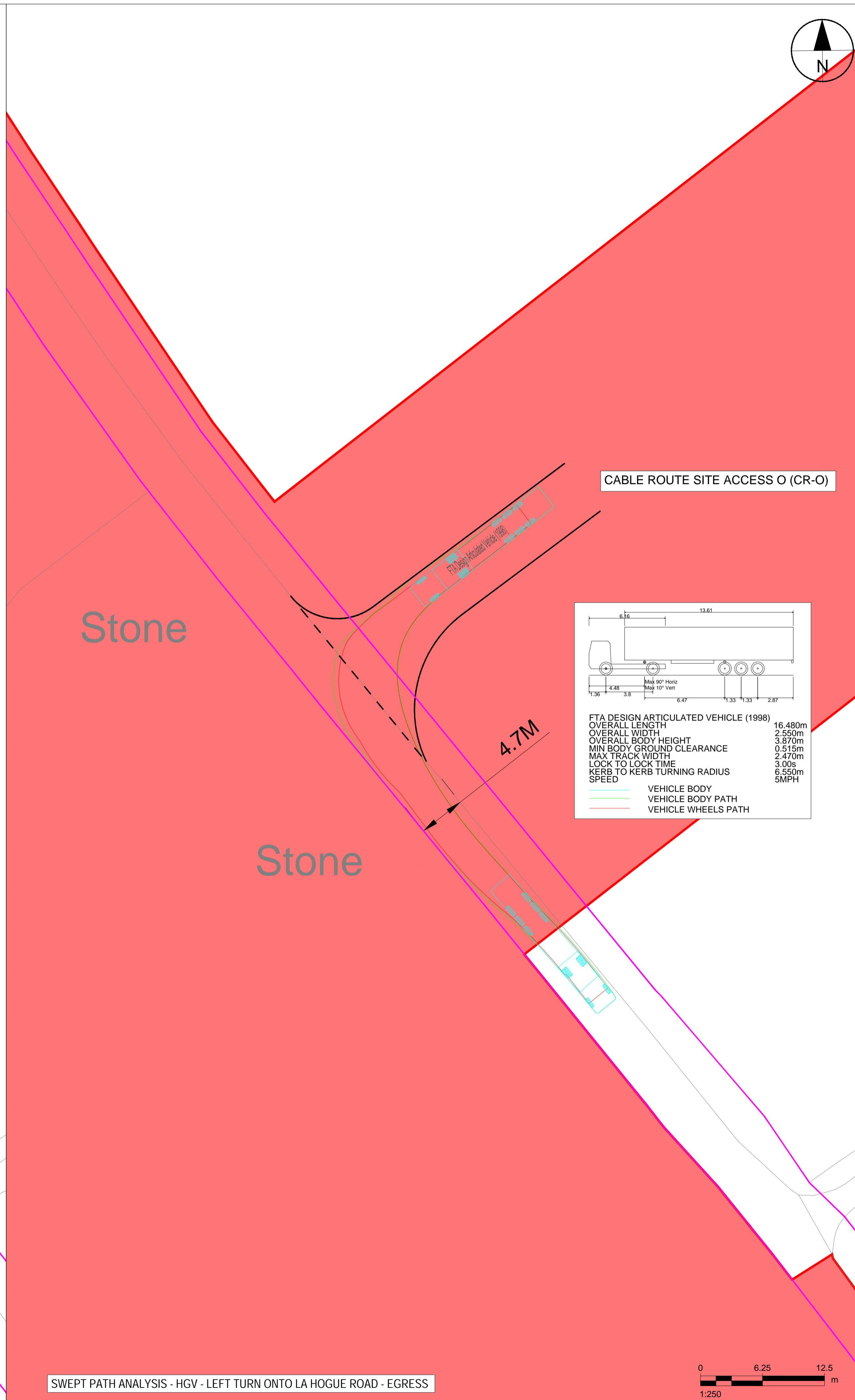

SWEPT PATH ANALYSIS - HGV - LEFT TURN ONTO LA HOGUE ROAD - EGRESS

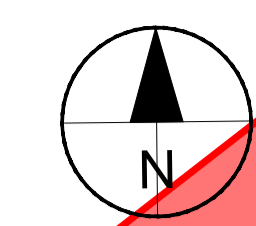

SUNNICA Ltd

AECOM
 AECOM House, 63-77 Victoria Street,
 St. Albans, Hertfordshire, AL1 3ER
 +44(0)1727 535000 tel
 +44(0)1727 535099 fax
 www.aecom.com

1. ALL DIMENSIONS ARE IN METRES UNLESS NOTED OTHERWISE
2. ALL JUNCTION LAYOUTS AREA INDICATIVE
3. THIS DRAWING IS BASED ON ORDNANCE SURVEY MASTERMAP MAPPING, AND AS SUCH, ALL INFORMATION SHOWN IS APPROXIMATE ONLY.
4. ALL ROAD WIDTHS SHOWN, AS WELL AS POSITIONS OF EXISTING STREET FURNITURE, ARE APPROXIMATE ONLY.
5. VEHICLE TRACKING SHOWN IS INDICATIVE ONLY, AND REPRESENTS ASSUMED DELIVERY ROUTE(S) AND APPROXIMATE VEHICLE SIZE. SPECIFIC VEHICLE TO BE DETERMINED BY EQUIPMENT SUPPLIER / HAULIER.
6. DEFINITIVE VEHICLE TRACKING OF SPECIFIC DELIVERY VEHICLE TO BE CARRIED OUT BY HAULIER, TO ENSURE DESIRED MANOEUVRES ARE ACHIEVABLE, AND TO CONFIRM ANY REQUIRED ROAD WIDENING, TEMPORARY WORKS, etc.
7. ORDER LIMITS ARE TO THE OUTER EDGE OF THE RED LINE, WHICH IS AS PER PUBLISHED IN THE DCO DOCUMENTATION.

- ORDER LIMITS
- INDICATIVE JUNCTION LAYOUT
- CAMBRIDGESHIRE COUNTY COUNCIL HIGHWAY BOUNDARY

THE ACCESS LOCATIONS ACROSS GRID CONNECTION ROUTES A AND B WILL BE RE-INSTATED TO THEIR CONDITION PRIOR TO THE CONSTRUCTION PHASE; HOWEVER, THE RIGHTS TO UTILISE THESE ACCESS POINTS WILL BE RETAINED DURING OPERATION AND SECURED THROUGH THE DCO TO ALLOW ACCESS FOR MAINTENANCE, IF REQUIRED. ACCESS TO THE GRID CONNECTION ROUTES A AND B IS NOT REQUIRED DURING DECOMMISSIONING AS THE CABLE AND INFRASTRUCTURE WILL REMAIN IN-SITU.

I/R	DATE	DESCRIPTION
D	2023-03-03	DEADLINE 7
C	2022-11-28	MINOR UPDATE DEADLINE 3A
B	2022-11-11	SECOD ISSUE
A	2022-09-23	FIRST ISSUE



60589004

CABLE ROUTE (CR-O)
 SITE ACCESS O
 LA HOGUE ROAD (SHEET 1 OF 2)

ACM-60589004-AMR-DR-0039

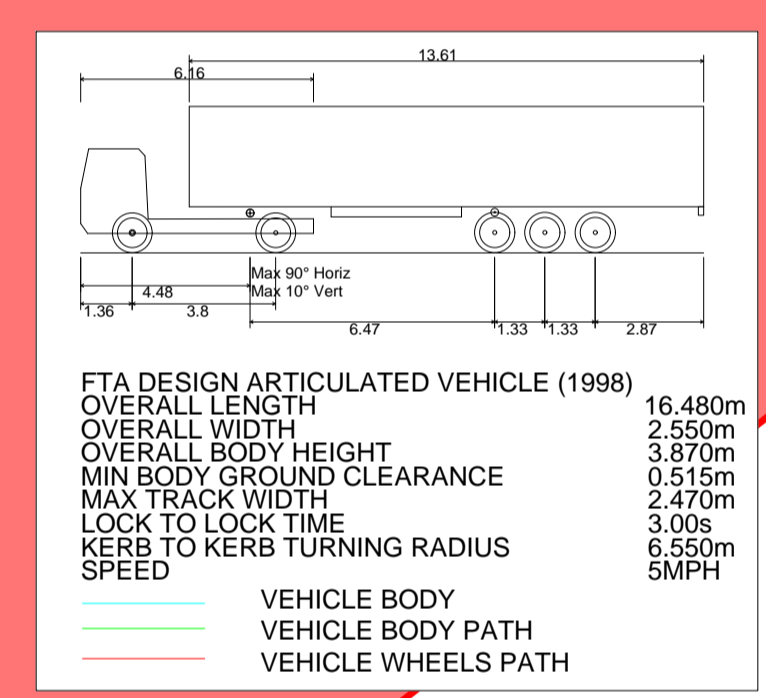

This drawing includes Ordnance Survey material with the permission of Ordnance Survey on behalf of The Controller of Her Majesty's Stationery Office © Crown copyright and database rights 2021. Ordnance Survey 0100031673.

This plan contains Cambridgeshire County Council asset information plotted against current Ordnance Survey mapping as accurately as possible. This data is supplied under the Open Government Licence (OGL; currently version 3). <http://www.nationalarchives.gov.uk/doc/open-government-licence/version/3/>

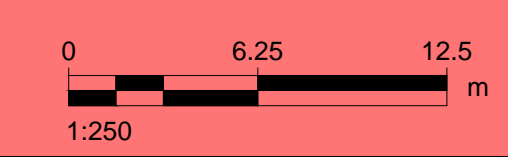

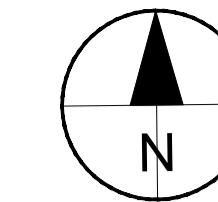

AECOM
AECOM House, 63-77 Victoria Street,
St. Albans, Hertfordshire, AL1 3ER
+44(0)1727 535000 tel
+44(0)1727 535099 fax
www.aecom.com

1. ALL DIMENSIONS ARE IN METRES UNLESS NOTED OTHERWISE
2. ALL JUNCTION LAYOUTS AREA INDICATIVE
3. THIS DRAWING IS BASED ON ORDNANCE SURVEY MASTERMAP MAPPING, AND AS SUCH, ALL INFORMATION SHOWN IS APPROXIMATE ONLY.
4. ALL ROAD WIDTHS SHOWN, AS WELL AS POSITIONS OF EXISTING STREET FURNITURE, ARE APPROXIMATE ONLY.
5. VEHICLE TRACKING SHOWN IS INDICATIVE ONLY, AND REPRESENTS ASSUMED DELIVERY ROUTE(S) AND APPROXIMATE VEHICLE SIZE. SPECIFIC VEHICLE TO BE DETERMINED BY EQUIPMENT SUPPLIER / HAULIER.
6. DEFINITIVE VEHICLE TRACKING OF SPECIFIC DELIVERY VEHICLE TO BE CARRIED OUT BY HAULIER, TO ENSURE DESIRED MANOEUVRES ARE ACHIEVABLE, AND TO CONFIRM ANY REQUIRED ROAD WIDENING, TEMPORARY WORKS, etc.
7. ORDER LIMITS ARE TO THE OUTER EDGE OF THE RED LINE, WHICH IS AS PER PUBLISHED IN THE DCO DOCUMENTATION.

- ORDER LIMITS
- INDICATIVE JUNCTION LAYOUT
- VEGETATION REMOVAL REQUIRED
- TEMPORARY TRAFFIC SIGNALS
- TEMPORARY SPEED REDUCTION
- ACHIEVABLE SITE ACCESS VISIBILITY
- CAMBRIDGESHIRE COUNTY COUNCIL HIGHWAY BOUNDARY

I/R	DATE	DESCRIPTION
D	2023-03-03	DEADLINE 7
B	2022-11-28	MINOR UPDATE DEADLINE 3A
A	2022-11-11	FIRST ISSUE



60589004

CABLE ROUTE (CR-O)
SITE ACCESS O, LA HOGUE ROAD
TEMPORARY TRAFFIC SIGNALS
AND VISIBILITY (SHEET 2 OF 2)
SHEET NUMBER

ACM-60589004-AMR-DR-0040

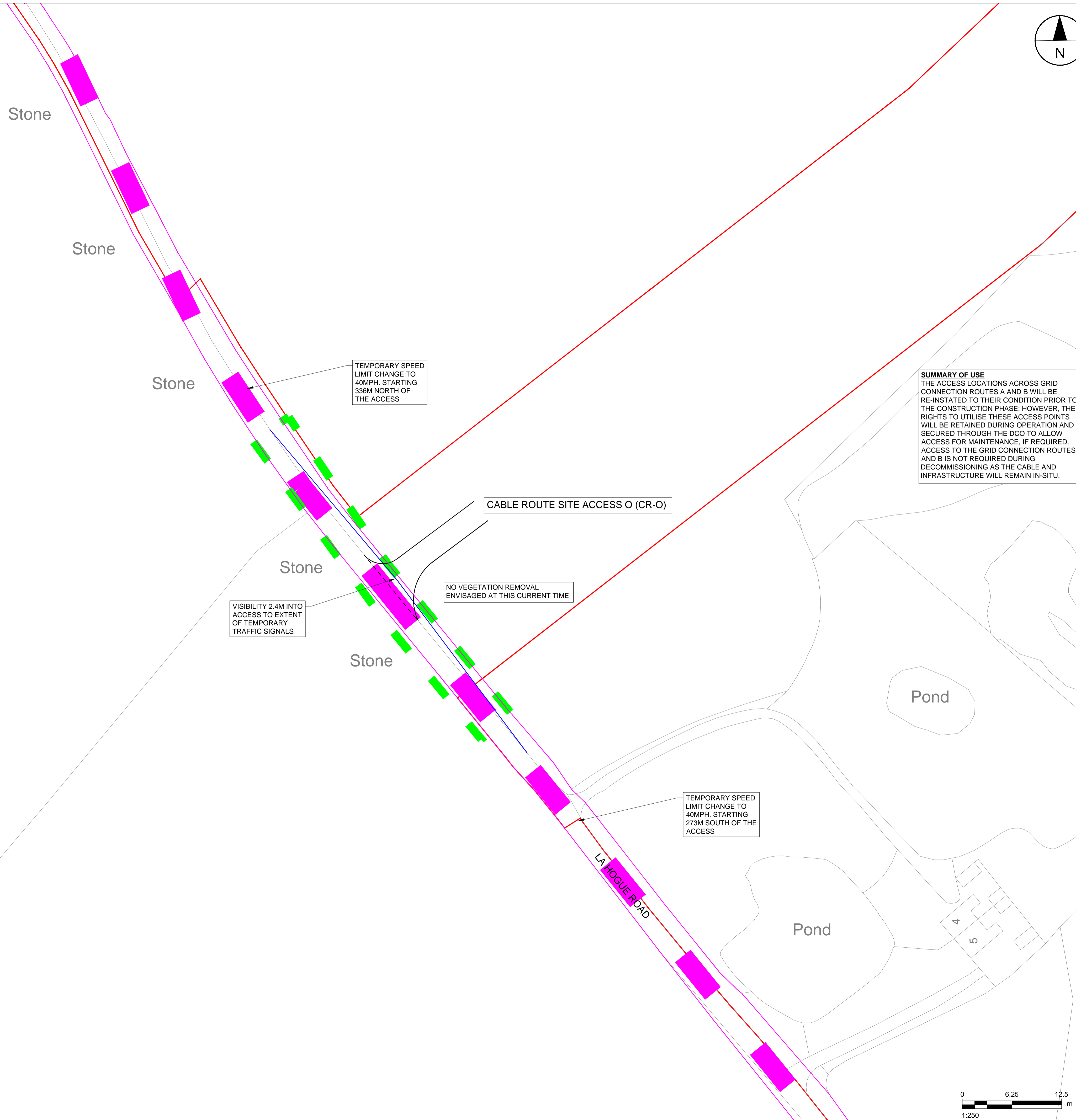

SUMMARY OF USE
THE ACCESS LOCATIONS ACROSS GRID CONNECTION ROUTES A AND B WILL BE RE-INSTATED TO THEIR CONDITION PRIOR TO THE CONSTRUCTION PHASE; HOWEVER, THE RIGHTS TO UTILISE THESE ACCESS POINTS WILL BE RETAINED DURING OPERATION AND SECURED THROUGH THE DCO TO ALLOW ACCESS FOR MAINTENANCE, IF REQUIRED. ACCESS TO THE GRID CONNECTION ROUTES A AND B IS NOT REQUIRED DURING DECOMMISSIONING AS THE CABLE AND INFRASTRUCTURE WILL REMAIN IN-SITU.

This drawing includes Ordnance Survey material with the permission of Ordnance Survey on behalf of The Controller of Her Majesty's Stationery Office © Crown copyright and database rights 2021. Ordnance Survey 0100031673.

This plan contains Cambridgeshire County Council asset information plotted against current Ordnance Survey mapping as accurately as possible. This data is supplied under the Open Government Licence (OGL; currently version 3). <http://www.nationalarchives.gov.uk/doc/open-government-licence/version/3/>

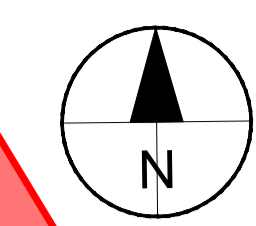
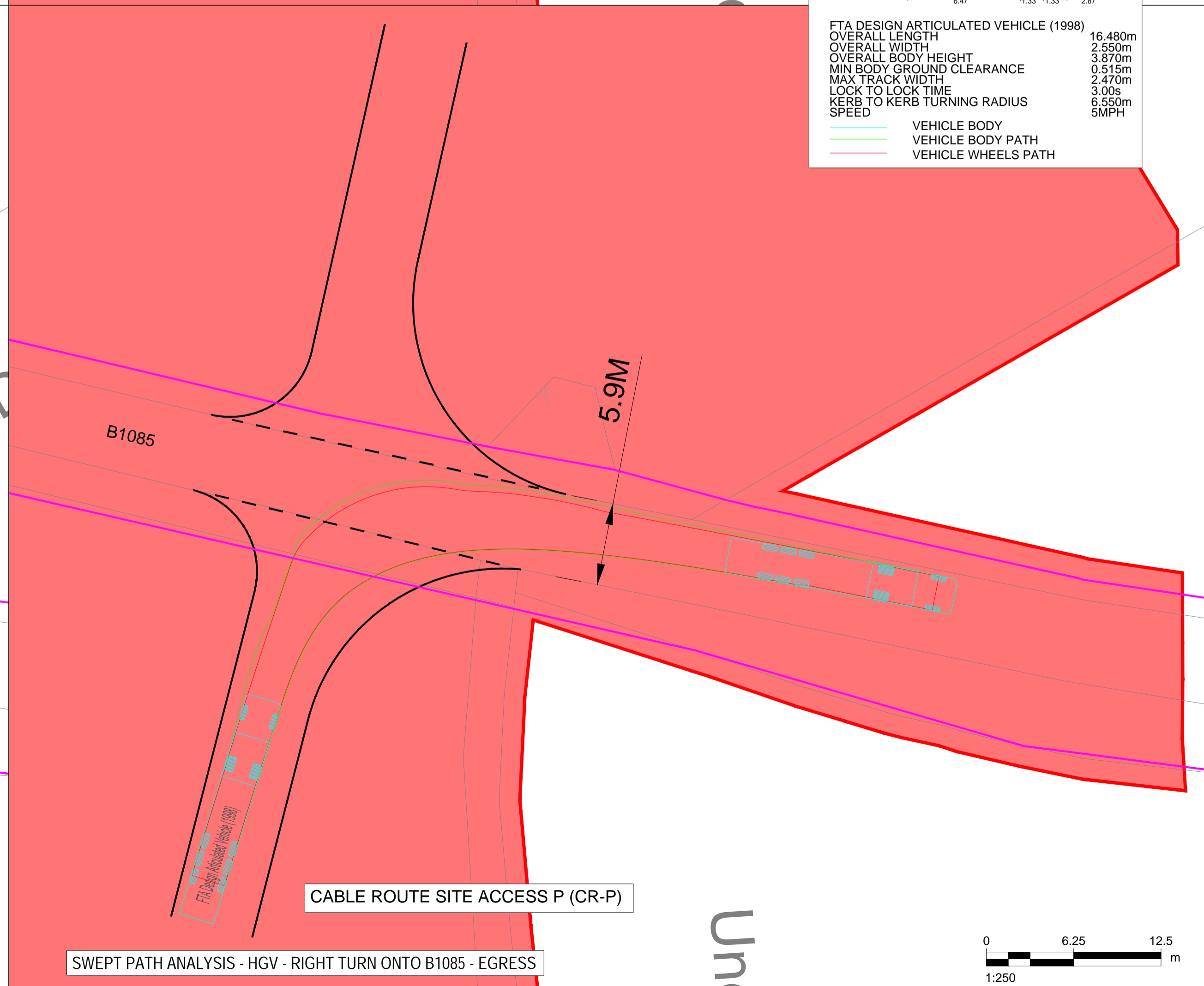
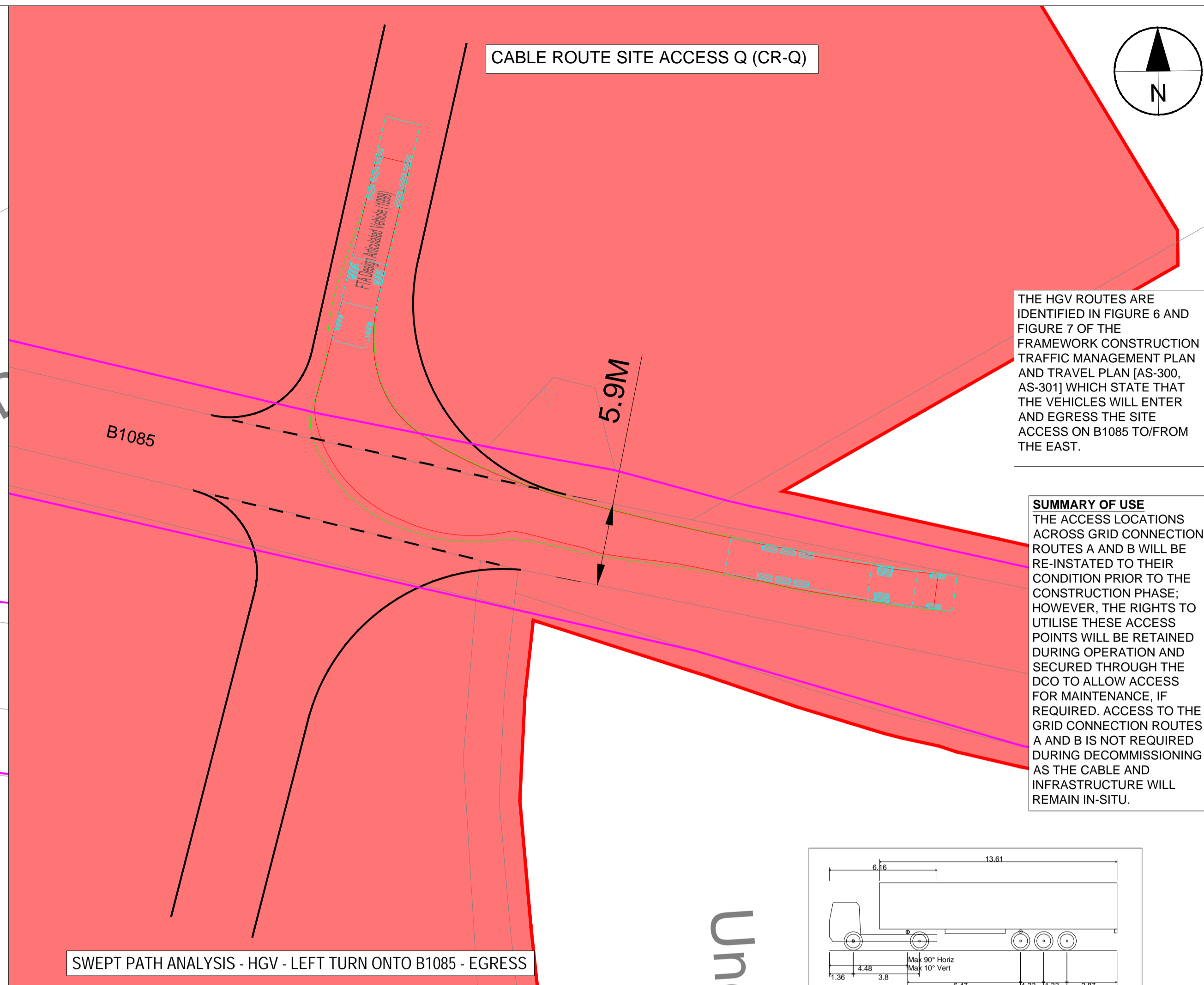
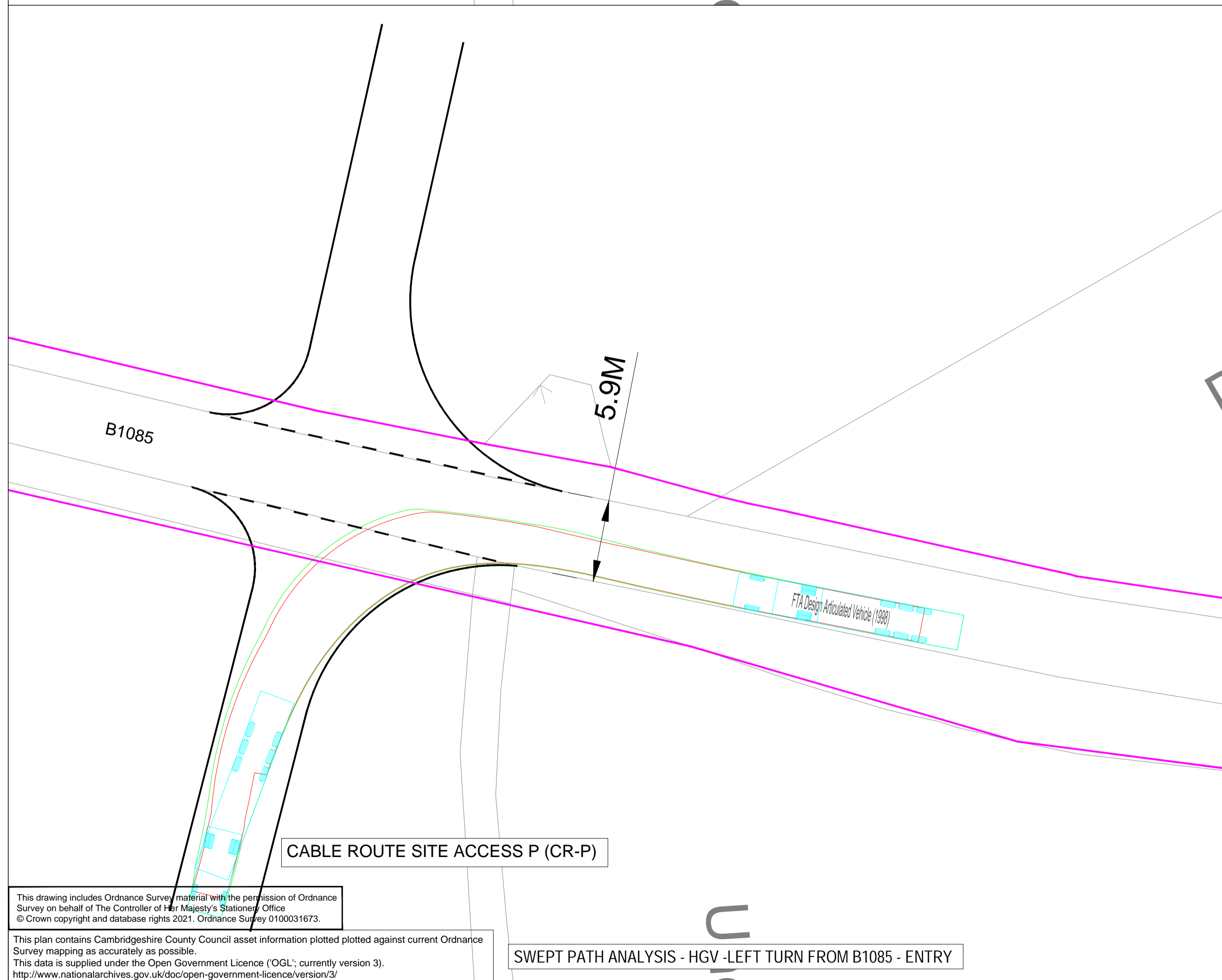
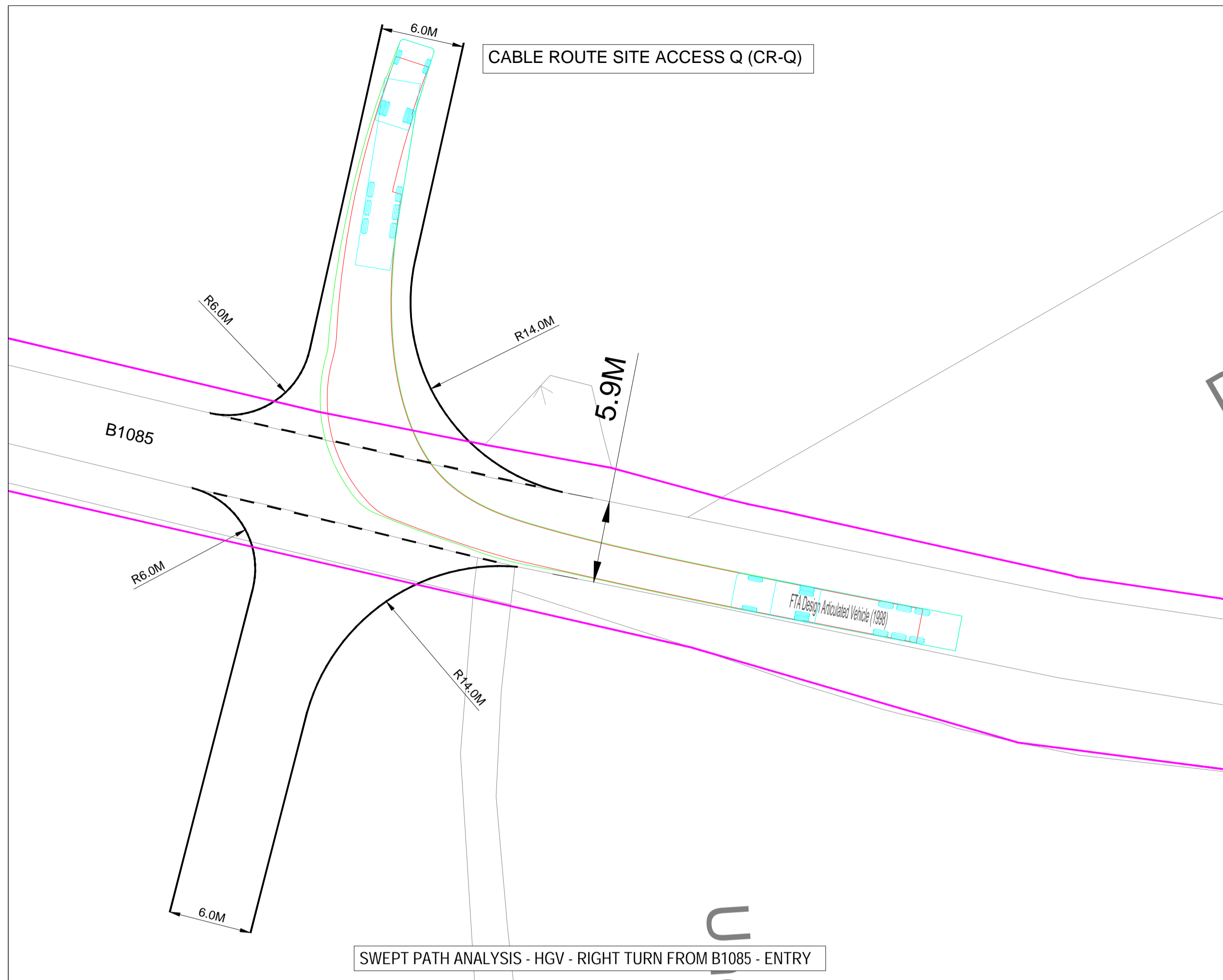

THE HGV ROUTES ARE IDENTIFIED IN FIGURE 6 AND FIGURE 7 OF THE FRAMEWORK CONSTRUCTION TRAFFIC MANAGEMENT PLAN AND TRAVEL PLAN (AS-300, AS-301) WHICH STATE THAT THE VEHICLES WILL ENTER AND EGRESS THE SITE ACCESS ON B1085 TO/FROM THE EAST.

SUMMARY OF USE
THE ACCESS LOCATIONS ACROSS GRID CONNECTION ROUTES A AND B WILL BE RE-INSTATED TO THEIR CONDITION PRIOR TO THE CONSTRUCTION PHASE; HOWEVER, THE RIGHTS TO UTILISE THESE ACCESS POINTS WILL BE RETAINED DURING OPERATION AND SECURED THROUGH THE DCO TO ALLOW ACCESS FOR MAINTENANCE, IF REQUIRED. ACCESS TO THE GRID CONNECTION ROUTES A AND B IS NOT REQUIRED DURING DECOMMISSIONING AS THE CABLE AND INFRASTRUCTURE WILL REMAIN IN-SITU.

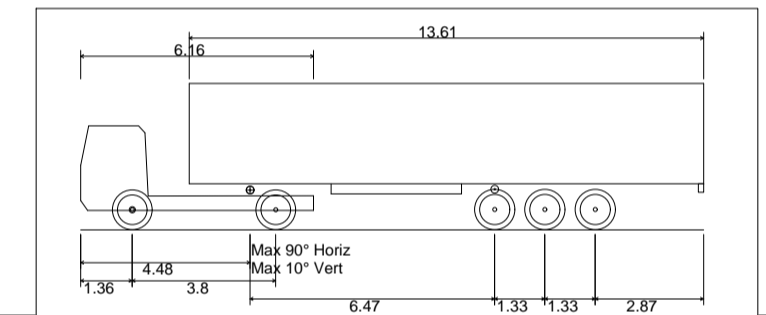

FTA DESIGN ARTICULATED VEHICLE (1998)	16.480m
OVERALL LENGTH	2.550m
OVERALL WIDTH	3.870m
OVERALL BODY HEIGHT	0.515m
MIN BODY GROUND CLEARANCE	2.470m
MAX TRACK WIDTH	3.00s
LOCK TO LOCK TIME	6.550m
KERB TO KERB TURNING RADIUS	5MPH
SPEED	
VEHICLE BODY	
VEHICLE BODY PATH	
VEHICLE WHEELS PATH	

AECOM

PROJECT

sunnica
energy farm

CLIENT
SUNNICA Ltd

CONSULTANT
AECOM
AECOM House, 63-77 Victoria Street,
St. Albans, Hertfordshire, AL1 3ER
+44(0)1727 535000 tel
+44(0)1727 535099 fax
www.aecom.com

NOTE

1. ALL DIMENSIONS ARE IN METRES UNLESS NOTED OTHERWISE
2. ALL JUNCTION LAYOUTS AREA INDICATIVE
3. THIS DRAWING IS BASED ON ORDNANCE SURVEY MASTERMAP MAPPING, AND AS SUCH, ALL INFORMATION SHOWN IS APPROXIMATE ONLY.
4. ALL ROAD WIDTHS SHOWN, AS WELL AS POSITIONS OF EXISTING STREET FURNITURE, ARE APPROXIMATE ONLY.
5. VEHICLE TRACKING SHOWN IS INDICATIVE ONLY, AND REPRESENTS ASSUMED DELIVERY ROUTE(S) AND APPROXIMATE VEHICLE SIZE. SPECIFIC VEHICLE TO BE DETERMINED BY EQUIPMENT SUPPLIER / HAULIER.
6. DEFINITIVE VEHICLE TRACKING OF SPECIFIC DELIVERY VEHICLE TO BE CARRIED OUT BY HAULIER, TO ENSURE DESIRED MANOEUVRES ARE ACHIEVABLE, AND TO CONFIRM ANY REQUIRED ROAD WIDENING, TEMPORARY WORKS, etc.
7. ORDER LIMITS ARE TO THE OUTER EDGE OF THE RED LINE, WHICH IS AS PER PUBLISHED IN THE DCO DOCUMENTATION.

KEY

- ORDER LIMITS
- INDICATIVE JUNCTION LAYOUT
- CAMBRIDGESHIRE COUNTY COUNCIL HIGHWAY BOUNDARY

TRAFFIC REGULATION MEASURES
TO PROVIDE SAFE ENTRY AND EGRESS OF THE SITE ACCESSES, TEMPORARY TRAFFIC SIGNALS AND TEMPORARY SPEED LIMIT REDUCTIONS ARE PROPOSED WHILST THE SITE ACCESS IS IN USE DURING THE CONSTRUCTION PERIOD. THESE ARE SHOWN ON SHEET NUMBER 60589004-TRM-TM-010 IN THE TRAFFIC REGULATION MEASURES PLAN TEMPORARY MEASURES.

ISSUE/REVISION

I/R	DATE	DESCRIPTION
D	2023-03-03	DEADLINE 7
C	2022-11-28	MINOR UPDATE DEADLINE 3A
B	2022-11-11	SECOND ISSUE
A	2022-09-23	FIRST ISSUE

KEY PLAN

PROJECT NUMBER
60589004

SHEET TITLE
CABLE ROUTE (CR-P) & (CR-Q)
SITE ACCESS P & Q
B1085 (SHEET 1 OF 2)

SHEET NUMBER
ACM-60589004-AMR-DR-0041

0 6.25 12.5
1:250 m

This drawing includes Ordnance Survey material with the permission of Ordnance Survey on behalf of The Controller of Her Majesty's Stationery Office © Crown copyright and database rights 2021. Ordnance Survey 0100031673.

This plan contains Cambridgeshire County Council asset information plotted against current Ordnance Survey mapping as accurately as possible. This data is supplied under the Open Government Licence (OGL; currently version 3). <http://www.nationalarchives.gov.uk/doc/open-government-licence/version/3/>

Printed on Recycled Content Paper

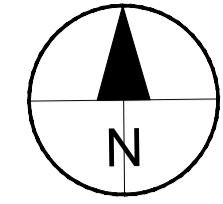

AECOM
AECOM House, 63-77 Victoria Street,
St. Albans, Hertfordshire, AL1 3ER
+44(0)1727 535000 tel
+44(0)1727 535099 fax
www.aecom.com

1. ALL DIMENSIONS ARE IN METRES UNLESS NOTED OTHERWISE
2. ALL JUNCTION LAYOUTS AREA INDICATIVE
3. THIS DRAWING IS BASED ON ORDNANCE SURVEY MASTERMAP MAPPING, AND AS SUCH, ALL INFORMATION SHOWN IS APPROXIMATE ONLY.
4. ALL ROAD WIDTHS SHOWN, AS WELL AS POSITIONS OF EXISTING STREET FURNITURE, ARE APPROXIMATE ONLY.
5. VEHICLE TRACKING SHOWN IS INDICATIVE ONLY, AND REPRESENTS ASSUMED DELIVERY ROUTE(S) AND APPROXIMATE VEHICLE SIZE. SPECIFIC VEHICLE TO BE DETERMINED BY EQUIPMENT SUPPLIER / HAULIER.
6. DEFINITIVE VEHICLE TRACKING OF SPECIFIC DELIVERY VEHICLE TO BE CARRIED OUT BY HAULIER, TO ENSURE DESIRED MANOEUVRES ARE ACHIEVABLE, AND TO CONFIRM ANY REQUIRED ROAD WIDENING, TEMPORARY WORKS, etc.
7. ORDER LIMITS ARE TO THE OUTER EDGE OF THE RED LINE, WHICH IS AS PER PUBLISHED IN THE DCO DOCUMENTATION.

SUMMARY OF USE
THE ACCESS LOCATIONS ACROSS GRID CONNECTION ROUTES A AND B WILL BE RE-INSTATED TO THEIR CONDITION PRIOR TO THE CONSTRUCTION PHASE; HOWEVER, THE RIGHTS TO UTILISE THESE ACCESS POINTS WILL BE RETAINED DURING OPERATION AND SECURED THROUGH THE DCO TO ALLOW ACCESS FOR MAINTENANCE, IF REQUIRED. ACCESS TO THE GRID CONNECTION ROUTES A AND B IS NOT REQUIRED DURING DECOMMISSIONING AS THE CABLE AND INFRASTRUCTURE WILL REMAIN IN-SITU.

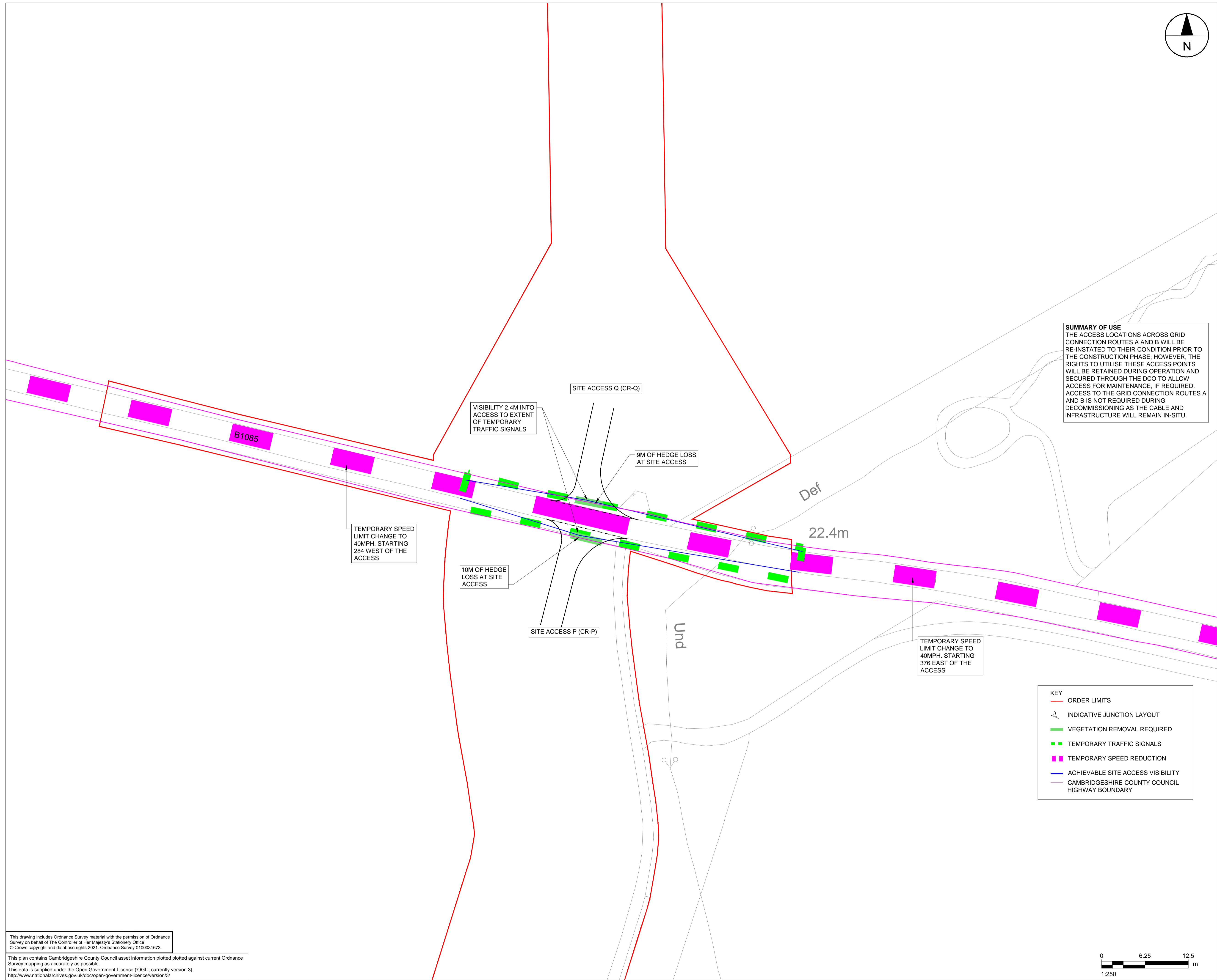

TEMPORARY SPEED LIMIT CHANGE TO 40MPH, STARTING 284 WEST OF THE ACCESS

VISIBILITY 2.4M INTO ACCESS TO EXTENT OF TEMPORARY TRAFFIC SIGNALS

SITE ACCESS Q (CR-Q)

9M OF HEDGE LOSS AT SITE ACCESS

10M OF HEDGE LOSS AT SITE ACCESS

SITE ACCESS P (CR-P)

Def

22.4m

Und

TEMPORARY SPEED LIMIT CHANGE TO 40MPH, STARTING 376 EAST OF THE ACCESS

KEY

- ORDER LIMITS
- INDICATIVE JUNCTION LAYOUT
- VEGETATION REMOVAL REQUIRED
- TEMPORARY TRAFFIC SIGNALS
- TEMPORARY SPEED REDUCTION
- ACHIEVABLE SITE ACCESS VISIBILITY
- CAMBRIDGESHIRE COUNTY COUNCIL HIGHWAY BOUNDARY

TRAFFIC REGULATION MEASURES
TO PROVIDE SAFE ENTRY AND EGRESS OF THE SITE ACCESSES, TEMPORARY TRAFFIC SIGNALS AND TEMPORARY SPEED LIMIT REDUCTIONS ARE PROPOSED WHILST THE SITE ACCESS IS IN USE DURING THE CONSTRUCTION PERIOD. THESE ARE SHOWN ON SHEET NUMBER 60589004-TRM-TM-010 IN THE TRAFFIC REGULATION MEASURES PLAN TEMPORARY MEASURES.

ISSUE/REVISION

I/R	DATE	DESCRIPTION
C	2023-03-03	DEADLINE 7
B	2022-11-28	MINOR UPDATE DEADLINE 3A
A	2022-11-11	FIRST ISSUE

KEY PLAN

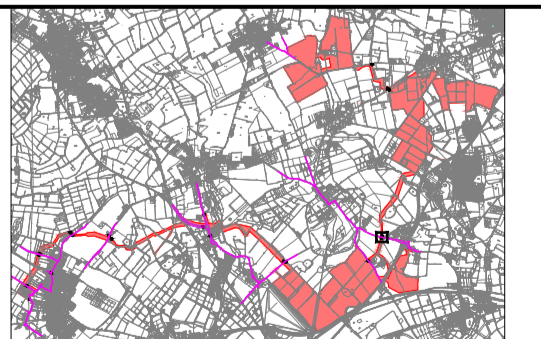

PROJECT NUMBER

60589004

SHEET TITLE

CABLE ROUTE (CR-P) & (CR-Q)
SITE ACCESS P & Q, B1085
TEMPORARY TRAFFIC SIGNALS
AND VISIBILITY (SHEET 2 OF 2)
SHEET NUMBER

ACM-60589004-AMR-DR-0042

This drawing includes Ordnance Survey material with the permission of Ordnance Survey on behalf of The Controller of Her Majesty's Stationery Office © Crown copyright and database rights 2021. Ordnance Survey 0100031673.

This plan contains Cambridgeshire County Council asset information plotted against current Ordnance Survey mapping as accurately as possible. This data is supplied under the Open Government Licence (OGL; currently version 3). <http://www.nationalarchives.gov.uk/doc/open-government-licence/version/3/>